



**Automatización Eléctrica**  
Especialistas en Automatización

At the end of this document you will find links to products related to this catalog. You can go directly to our shop by clicking [HERE](#). [HERE](#)

# Printed-circuit board connector - PTS 1,5/ 3-PH-5,0 - 1805520

Please be informed that the data shown in this PDF Document is generated from our Online Catalog. Please find the complete data in the user's documentation. Our General Terms of Use for Downloads are valid (<http://phoenixcontact.com/download>)

Plug component, Nominal current: 10 A, Rated voltage (III/2): 400 V, Number of positions: 3, Pitch: 5 mm, Connection method: Push-in spring connection, Color: green, Contact surface: Tin



The figure shows a 10-position version of the product

## Key Commercial Data

|              |                     |
|--------------|---------------------|
| Packing unit | 250 STK             |
| GTIN         | <br>4 046356 679138 |

## Technical data

### Dimensions

|             |         |
|-------------|---------|
| Pitch       | 5.00 mm |
| Dimension a | 10 mm   |

### General

|  |                     |
|--|---------------------|
| Range of articles                      | PTS 1,5/..-PH       |
| Insulating material group              | I                   |
| Rated surge voltage (III/3)            | 4 kV                |
| Rated surge voltage (III/2)            | 4 kV                |
| Rated surge voltage (II/2)             | 4 kV                |
| Rated voltage (III/3)                  | 250 V               |
| Rated voltage (III/2)                  | 400 V               |
| Rated voltage (II/2)                   | 600 V               |
| Nominal current $I_N$                  | 10 A                |
| Nominal cross section                  | 1.5 mm <sup>2</sup> |
| Insulating material                    | PA                  |
| Flammability rating according to UL 94 | V0                  |
| Stripping length                       | 8 mm                |
| Number of positions                    | 3                   |

### Connection data

|                                    |                     |
|------------------------------------|---------------------|
| Conductor cross section solid min. | 0.2 mm <sup>2</sup> |
| Conductor cross section solid max. | 2.5 mm <sup>2</sup> |

# Printed-circuit board connector - PTS 1,5/ 3-PH-5,0 - 1805520

## Technical data

### Connection data

|  |                        |
|--|------------------------|
| Conductor cross section flexible min.                                      | 0.2 mm <sup>2</sup>    |
| Conductor cross section flexible max.                                      | 2.5 mm <sup>2</sup>    |
| Conductor cross section flexible, with ferrule without plastic sleeve min. | 0.25 mm <sup>2</sup>   |
| Conductor cross section flexible, with ferrule without plastic sleeve max. | 1.5 mm <sup>2</sup>    |
| Conductor cross section flexible, with ferrule with plastic sleeve min.    | 0.25 mm <sup>2</sup> 1 |
| Conductor cross section flexible, with ferrule with plastic sleeve max.    | 1 mm <sup>2</sup>      |
| Conductor cross section AWG min.   | 26                     |
| Conductor cross section AWG max.   | 14                     |

### Standards and Regulations

|  |    |
|--|----|
| Flammability rating according to UL 94 | V0 |
|--|----|

## Classifications

### eCl@ss

|            |          |
|------------|----------|
| eCl@ss 4.0 | 272607xx |
| eCl@ss 4.1 | 27141109 |
| eCl@ss 5.0 | 27141190 |
| eCl@ss 5.1 | 27141190 |
| eCl@ss 6.0 | 27260704 |
| eCl@ss 7.0 | 27440402 |
| eCl@ss 8.0 | 27440309 |

### ETIM

|          |          |
|----------|----------|
| ETIM 3.0 | EC001121 |
| ETIM 4.0 | EC002637 |
| ETIM 5.0 | EC002637 |

### UNSPSC

|               |          |
|---------------|----------|
| UNSPSC 6.01   | 30211801 |
| UNSPSC 7.0901 | 39121432 |
| UNSPSC 11     | 34131203 |
| UNSPSC 12.01  | 39121432 |
| UNSPSC 13.2   | 39121432 |

## Approvals

### Approvals

---

#### Approvals

EAC / VDE Gutachten mit Fertigungsüberwachung / IECCE CB Scheme

---

# Printed-circuit board connector - PTS 1,5/ 3-PH-5,0 - 1805520

## Approvals

Ex Approvals

Approvals submitted

## Approval details

|     |
|-----|
| EAC |
|-----|

|   |         |
|---|---------|
| VDE Gutachten mit Fertigungsüberwachung |         |
| mm <sup>2</sup> /AWG/kcmil              | 0.2-2.5 |
| Nominal current I <sub>N</sub>          | 10 A    |
| Nominal voltage U <sub>N</sub>          | 320 V   |

|                                |         |
|--------------------------------|---------|
| IECEE CB Scheme                |         |
| mm <sup>2</sup> /AWG/kcmil     | 0.2-2.5 |
| Nominal current I <sub>N</sub> | 10 A    |
| Nominal voltage U <sub>N</sub> | 320 V   |

## Drawings

Dimensional drawing

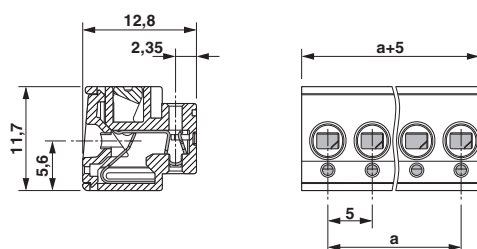

Diagram

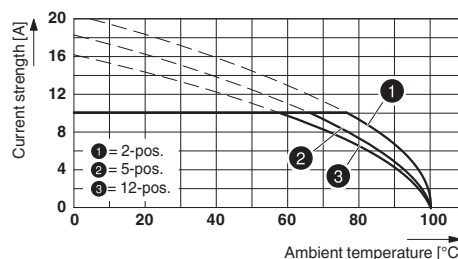

Type: PTS 1,5/...-PH-5,0 with PST 1,3/...-5,0

Phoenix Contact 2016 © - all rights reserved  
<http://www.phoenixcontact.com>

PHOENIX CONTACT GmbH & Co. KG  
Flachsmarktstr. 8  
32825 Blomberg  
Germany  
Tel. +49 5235 300  
Fax +49 5235 3 41200  
<http://www.phoenixcontact.com>



**Automatización Eléctrica**  
Especialistas en Automatización

Below is a list of articles with direct links to our shop Electric Automation Network where you can see:

- Quote per purchase volume in real time.
- Online documentation and datasheets of all products.
- Estimated delivery time enquiry in real time.
- Logistics systems for the shipment of materials almost anywhere in the world.
- Purchasing management, order record and tracking of shipments.

To access the product, [click on the green button.](#)

| Product  | Code    | Reference         | Product link               |
|--|---------|-------------------|----------------------------|
| Plug component, Nominal current: 10 A, Rated voltage (III/2): 400 V, Number of positions: 3, Pitch: 5 mm, Connection method: Push-in spring connection, Color: green, Contact surface: Tin | 1805520 | PTS 1,5/ 3-PH-5,0 | <a href="#">Buy on EAN</a> |