



Automatización Eléctrica
Especialistas en Automatización

At the end of this document you will find links to products related to this catalog. You can go directly to our shop by clicking [HERE](#). [HERE](#)

Panel feed-through terminal block - RWV 8 - 3073762

Please be informed that the data shown in this PDF Document is generated from our Online Catalog. Please find the complete data in the user's documentation. Our General Terms of Use for Downloads are valid (<http://phoenixcontact.com/download>)



Panel feed-through terminal block, Connection method: Bolt connection, Load current : 125 A, Cross section: 2.5 mm² - 35 mm², AWG 14 - 2, Connection direction of the conductor to plug-in direction: 90 °, Width: 20.3 mm, Color: gray

Why buy this product

- Easy grouping with engagement pin versions
- Quick and easy conductor connection thanks to hinged cover flaps with captive clamping nut
- Both terminal halves can be easily assembled by simply snapping them together
- Spring-loaded spacers protect the bolt connection against loosening
- Molded versions ensure maximum tightness of seal
- Touch-proof insulating housing in a new design
- Automatic compensation of the panel thickness via the snap principle integrated in the insulation housing

Key Commercial Data

Packing unit	10 STK
GTIN	 4 046356 368575

Technical data

General

Number of levels	1
Number of connections	2
Nominal cross section	35 mm ²
Color	gray
Insulating material	PA
Flammability rating according to UL 94	V0
Maximum load current	125 A
Rated surge voltage	6 kV
Degree of pollution	3
Overvoltage category	III
Insulating material group	I
Connection in acc. with standard	IEC 60947-7-1
Nominal current I _N	125 A
Maximum load current	125 A (with 35 mm ² conductor cross section)

Panel feed-through terminal block - RWV 8 - 3073762

Technical data

General

Nominal voltage U_N	1000 V
Open side panel	No
Number of positions	1

Dimensions

Width	20.3 mm
Plate thickness	1 mm ... 6 mm

Connection data

Note	Connection bolts
Connection side	Level 1 above 1 below 1
Connection method	Bolt connection
Conductor cross section solid min.	2.5 mm ²
Conductor cross section solid max.	35 mm ²
Conductor cross section flexible min.	2.5 mm ²
Conductor cross section flexible max.	35 mm ²
Conductor cross section AWG min.	14
Conductor cross section AWG max.	2
Screw thread	M8
Tightening torque, min	4.5 Nm
Tightening torque max	5 Nm

Standards and Regulations

Connection in acc. with standard	UL
	IEC 60947-7-1
	DIN 46 234
	DIN 46237
Flammability rating according to UL 94	V0

Classifications

eCl@ss

eCl@ss 4.0	27141131
eCl@ss 4.1	27141131
eCl@ss 5.0	27141134
eCl@ss 5.1	27141134
eCl@ss 6.0	27141134
eCl@ss 7.0	27141134
eCl@ss 8.0	27141134

ETIM

ETIM 2.0	EC001283
----------	----------

Panel feed-through terminal block - RWV 8 - 3073762

Classifications

ETIM

ETIM 3.0	EC001283
ETIM 4.0	EC001283
ETIM 5.0	EC001283

UNSPSC

UNSPSC 6.01	30211811
UNSPSC 7.0901	39121410
UNSPSC 11	39121410
UNSPSC 12.01	39121410
UNSPSC 13.2	39121410

Approvals

Approvals

Approvals

UL Recognized / EAC

Ex Approvals

Approvals submitted

Approval details

UL Recognized		
	B	C
Nominal current IN	115 A	115 A
Nominal voltage UN	600 V	600 V

EAC

Drawings

Panel feed-through terminal block - RWV 8 - 3073762

Dimensional drawing

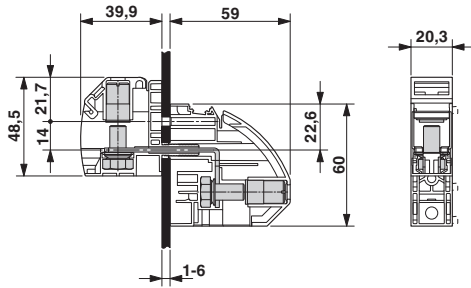

Dimensional drawing

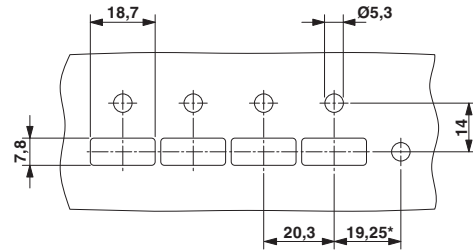

* Only when using the RW...-F flange plate

Phoenix Contact 2016 © - all rights reserved
<http://www.phoenixcontact.com>

PHOENIX CONTACT GmbH & Co. KG
Flachsmarktstr. 8
32825 Blomberg
Germany
Tel. +49 5235 300
Fax +49 5235 3 41200
<http://www.phoenixcontact.com>



Below is a list of articles with direct links to our shop Electric Automation Network where you can see:

- Quote per purchase volume in real time.
- Online documentation and datasheets of all products.
- Estimated delivery time enquiry in real time.
- Logistics systems for the shipment of materials almost anywhere in the world.
- Purchasing management, order record and tracking of shipments.

To access the product, [click on the green button.](#)

Product	Code	Reference	Product link
Panel feed-through terminal block, Connection method: Bolt connection, Load current : 125 A, Cross section: 2.5 mm ² - 35 mm ² , AWG 14 - 2, Connection direction of the conductor to plug-in direction: 90 °, Width: 20.3 mm, Color: gray	3073762	RWV 8	Buy on EAN