

Load feeder fuseless direct-on-line starting, 400 V AC 28...40 A, 24 V AC 50 Hz Size S2 Screw terminal on adapter Screw and snap-on mounting Type of coordination 2, Iq = 50 kA (also fulfills type of coordination 1) !!! Phased-out product !!! Successor is SIRIUS 3RA2



Figure similar

product brand name	SIRIUS
Product designation	non-fused load feeder
Design of the product	direct starter
Manufacturer's article number	
<ul style="list-style-type: none"> • of the supplied contactor • of the supplied circuit-breakers • of the supplied link module • of the supplied standard mounting rail adapter 	<ul style="list-style-type: none"> 3RT1035-1AB00 3RV1031-4FA10 3RA1931-1AA00 3RA1932-1AA00

General technical data	
Size of load feeder	S2
Product extension	
<ul style="list-style-type: none"> • Auxiliary switch • Insulation voltage rated value 	Yes 690 V
Degree of pollution	3
Surge voltage resistance rated value	6 kV
<ul style="list-style-type: none"> • protection class IP on the front 	IP20
Shock resistance	8g

Mechanical service life (switching cycles)	
<ul style="list-style-type: none"> • of contactor typical 	10 000 000
Type of assignment	2
<ul style="list-style-type: none"> • certificate of suitability 	UL / CSA / CCC / GL / LRS / BV / DNV / PRS
Reference code acc. to DIN EN 81346-2	Q

Ambient conditions

Installation altitude at height above sea level	
<ul style="list-style-type: none"> • maximum 	2 000 m
Ambient temperature	
<ul style="list-style-type: none"> • during operation 	-20 ... +70 °C
<ul style="list-style-type: none"> • during storage 	-55 ... +80 °C

Main circuit

Number of poles for main current circuit	3
design of the switching contact	electromechanical
adjustable pick-up value current of the current-dependent overload release	28 ... 40 A
Type of the motor protection	bimetal
Operating voltage	
<ul style="list-style-type: none"> • at AC-3 rated value maximum 	400 V
Operating current	
<ul style="list-style-type: none"> • at AC-3 — at 400 V rated value 	35 A
Operating power	
<ul style="list-style-type: none"> • at AC-3 — at 400 V rated value 	18.5 kW
No-load switching frequency	15 1/s

Control circuit/ Control

Type of voltage of the control supply voltage	AC
Control supply voltage 1 at AC	
<ul style="list-style-type: none"> • at 50 Hz rated value 	24 V
control supply voltage frequency	
<ul style="list-style-type: none"> • 1 rated value 	50 Hz

Auxiliary circuit

Number of NC contacts for auxiliary contacts	0
Number of NO contacts for auxiliary contacts	0
Number of CO contacts	
<ul style="list-style-type: none"> • for auxiliary contacts 	0

Protective and monitoring functions

Maximum short-circuit current breaking capacity (Icu)	
<ul style="list-style-type: none"> • at 400 V rated value 	50 kA

Short-circuit protection	
product function short circuit protection	Yes
Design of short-circuit protection	circuit-breakers
Installation/ mounting/ dimensions	
<ul style="list-style-type: none"> • mounting position 	with vertical mounting surface +/-90° rotatable, with vertical mounting surface +/- 22.5° tiltable to the front and back
Mounting type	snap-on fastening on 35 mm standard rail
Height	295 mm
Width	55 mm
Depth	173 mm
Required spacing	
<ul style="list-style-type: none"> • with side-by-side mounting <ul style="list-style-type: none"> — at the side • for grounded parts <ul style="list-style-type: none"> — forwards — Backwards — upwards — at the side • for live parts <ul style="list-style-type: none"> — forwards — Backwards — downwards — at the side 	0 mm 10 mm 0 mm 50 mm 10 mm 10 mm 10 mm 10 mm 0 mm 50 mm
Connections/ Terminals	
<ul style="list-style-type: none"> • Type of electrical connection for main current circuit 	screw-type terminals
Type of connectable conductor cross-sections	
<ul style="list-style-type: none"> • for main contacts <ul style="list-style-type: none"> — solid — stranded — finely stranded with core end processing • at AWG conductors for main contacts 	0.7 ... 35 mm ² , 2x (0.75 ... 25 mm ²) 0.7 ... 35 mm ² , 2x (0.75 ... 25 mm ²) 0.75 ... 25 mm ² , 2x (0.75 ... 16 mm ²) 2x (30 ... 2)
Connectable conductor cross-section for main contacts	
<ul style="list-style-type: none"> • single or multi-stranded • stranded • finely stranded with core end processing 	0.7 ... 35 mm ² 0.7 ... 35 mm ² 0.75 ... 25 mm ²
AWG number as coded connectable conductor cross section	
<ul style="list-style-type: none"> • for main contacts 	30 ... 2
Communication/ Protocol	

• protocol is supported PROFIBUS DP protocol	No
• protocol is supported PROFINET protocol	No
product function bus communication	No
Protocol is supported	
• AS-Interface protocol	No

Inputs/ Outputs	
• number of digital inputs	0

Certificates/ approvals

General Product Approval	For use in hazardous locations	Declaration of Conformity	Marine / Shipping
---------------------------------	---------------------------------------	----------------------------------	--------------------------



[Miscellaneous](#)



Marine / Shipping	other
--------------------------	--------------



LRS



RMRS



DNVGL.COM/AF

[Confirmation](#)

Further information

Information- and Downloadcenter (Catalogs, Brochures,...)

<https://www.siemens.com/ic10>

Industry Mall (Online ordering system)

<https://mall.industry.siemens.com/mall/en/en/Catalog/product?mlfb=3RA1130-4FB35-0AB0>

Cax online generator

<http://support.automation.siemens.com/WW/CAXorder/default.aspx?lang=en&mlfb=3RA1130-4FB35-0AB0>

Service&Support (Manuals, Certificates, Characteristics, FAQs,...)

<https://support.industry.siemens.com/cs/ww/en/ps/3RA1130-4FB35-0AB0>

Image database (product images, 2D dimension drawings, 3D models, device circuit diagrams, EPLAN macros, ...)

http://www.automation.siemens.com/bilddb/cax_de.aspx?mlfb=3RA1130-4FB35-0AB0&lang=en

Characteristic: Tripping characteristics, I²t, Let-through current

<https://support.industry.siemens.com/cs/ww/en/ps/3RA1130-4FB35-0AB0/char>

Further characteristics (e.g. electrical endurance, switching frequency)

<http://www.automation.siemens.com/bilddb/index.aspx?view=Search&mlfb=3RA1130-4FB35-0AB0&objecttype=14&gridview=view1>

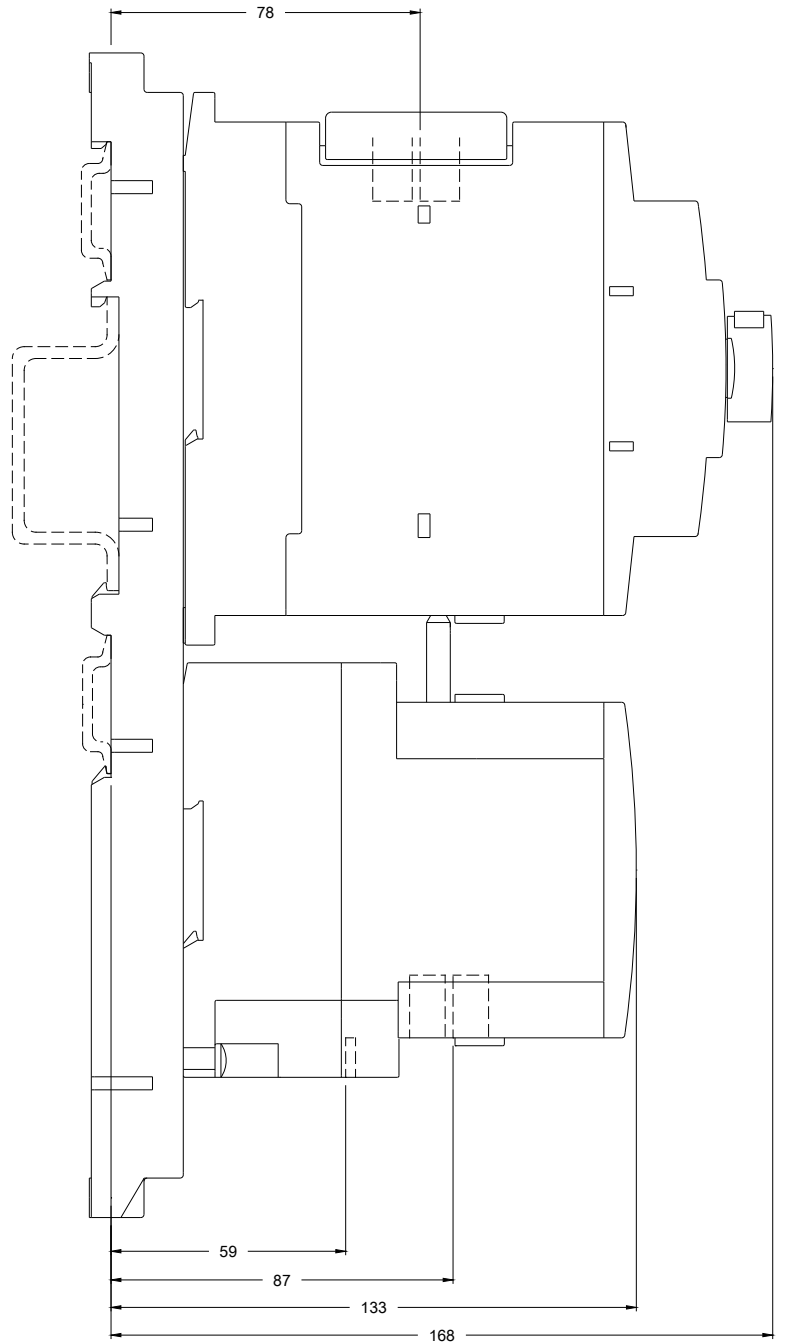
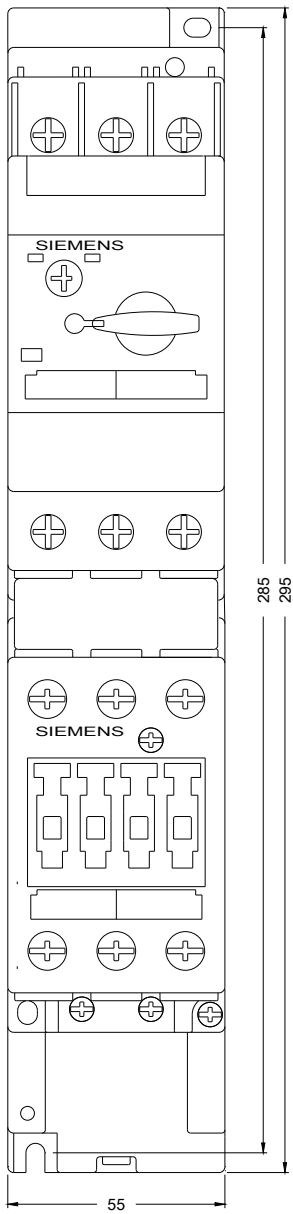

last modified:

08/13/2020