

Current transformer 63...630 A for 3RB22/23/24 Size S10/S12  
 Contactor mounting/stand-alone installation Main circuit: busbar  
 connection Auxiliary circuit: --



|  |  |
|--|--|
| product brand name   | SIRIUS                                       |
| Product designation  | Current measuring module                     |
| <b>General technical data</b>  |  |
| Type of protection according to ATEX directive 2014/34/EU  | Ex II (2) GD                                 |
| Certificate of suitability according to ATEX directive 2014/34/EU  | PTB 05 ATEX 3022                             |
| <b>Main circuit</b>  |  |
| adjustable pick-up value current of the current-dependent overload release                               | 63 ... 630 A                                 |
| <b>Installation/ mounting/ dimensions</b>  |  |
| Mounting type  | Contacteur mounting/stand-alone installation |
| <b>Connections/ Terminals</b>  |  |
| <ul style="list-style-type: none"> <li>Type of electrical connection for main current circuit</li> </ul> | screw-type terminals                         |
| <b>Certificates/ approvals</b>   |  |

|                          |                                |                           |
|--------------------------|--------------------------------|---------------------------|
| General Product Approval | For use in hazardous locations | Declaration of Conformity |
|--------------------------|--------------------------------|---------------------------|



|                           |                   |                   |
|---------------------------|-------------------|-------------------|
| Declaration of Conformity | Test Certificates | Marine / Shipping |
|---------------------------|-------------------|-------------------|

[Miscellaneous](#)

[Type Test Certificates/Test Report](#)

[Special Test Certificate](#)



|                   |       |
|-------------------|-------|
| Marine / Shipping | other |
|-------------------|-------|



[Confirmation](#)

### Further information

**Information- and Downloadcenter (Catalogs, Brochures,...)**

<https://www.siemens.com/ic10>

**Industry Mall (Online ordering system)**

<https://mall.industry.siemens.com/mall/en/en/Catalog/product?mlfb=3RB2966-2WH2>

**Cax online generator**

<http://support.automation.siemens.com/WW/CAXorder/default.aspx?lang=en&mlfb=3RB2966-2WH2>

**Service&Support (Manuals, Certificates, Characteristics, FAQs,...)**

<https://support.industry.siemens.com/cs/ww/en/ps/3RB2966-2WH2>

**Image database (product images, 2D dimension drawings, 3D models, device circuit diagrams, EPLAN macros, ...)**

[http://www.automation.siemens.com/bilddb/cax\\_de.aspx?mlfb=3RB2966-2WH2&lang=en](http://www.automation.siemens.com/bilddb/cax_de.aspx?mlfb=3RB2966-2WH2&lang=en)

**Characteristic: Tripping characteristics, I<sup>2</sup>t, Let-through current**

<https://support.industry.siemens.com/cs/ww/en/ps/3RB2966-2WH2/char>

**Further characteristics (e.g. electrical endurance, switching frequency)**

<http://www.automation.siemens.com/bilddb/index.aspx?view=Search&mlfb=3RB2966-2WH2&objecttype=14&gridview=view1>

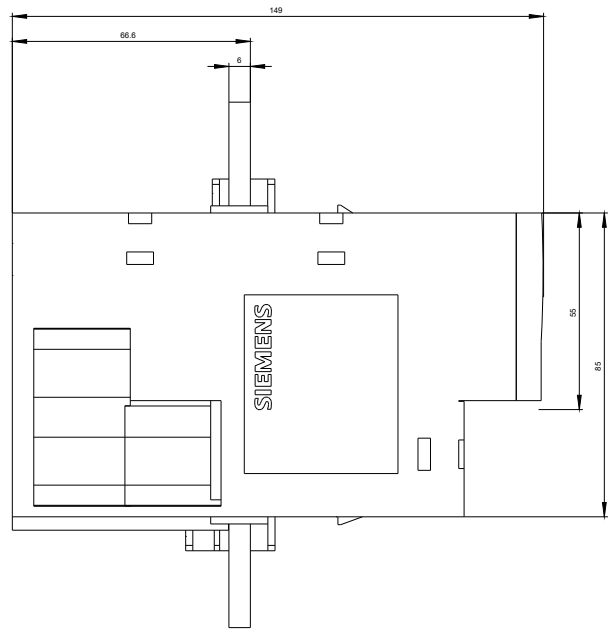
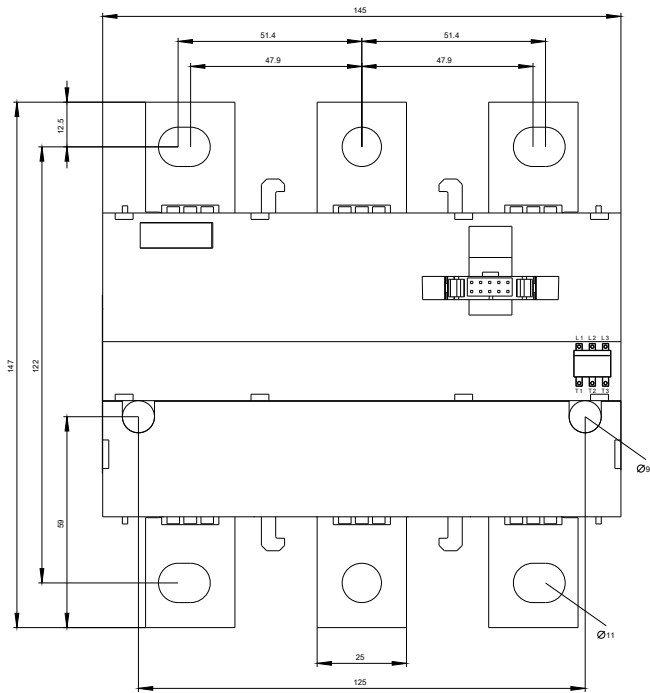

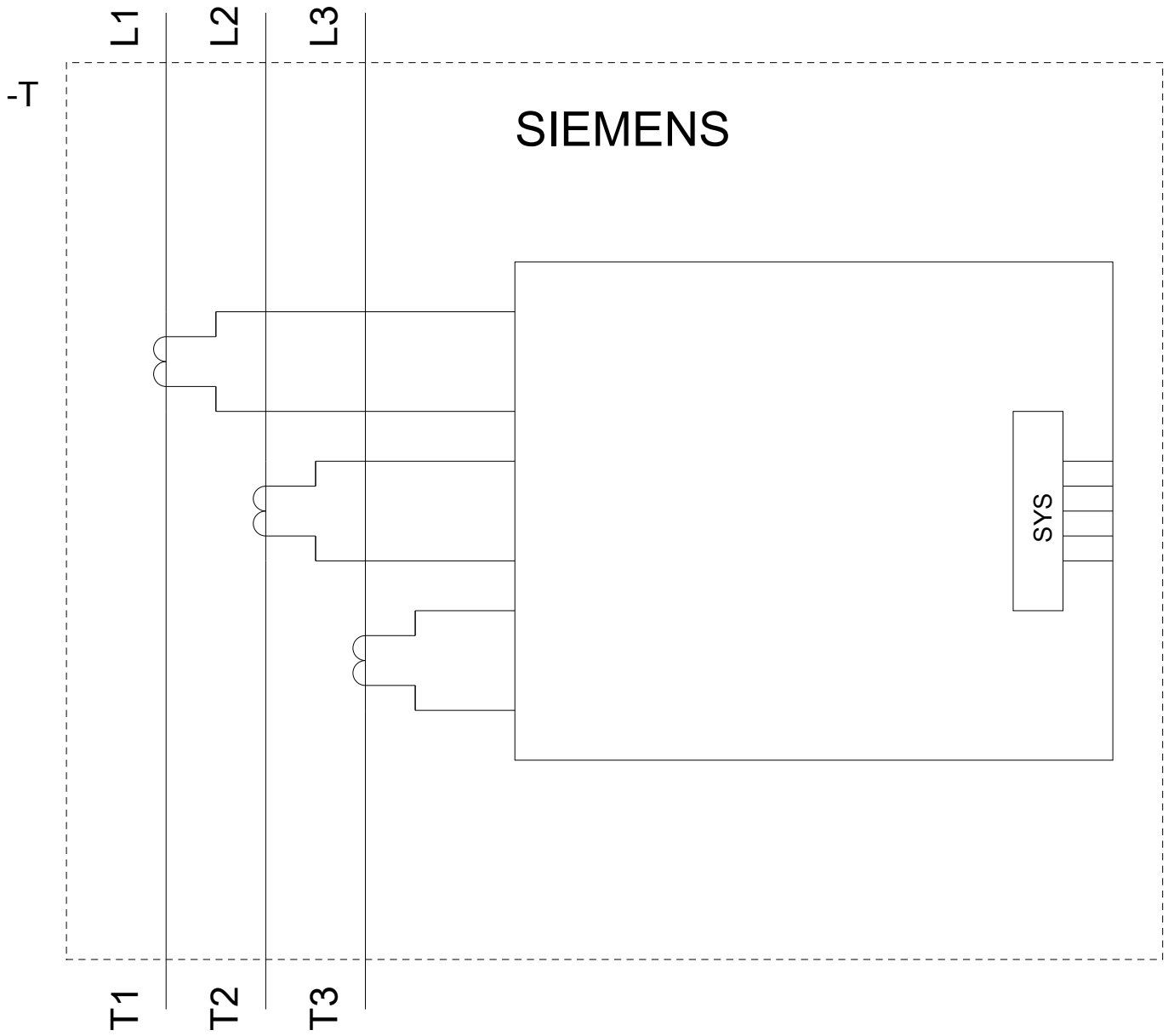

last modified:

08/13/2020