

Plug-in socket for PT relay 4 changeover contacts with logic isolation  
Spring-type terminal (push-in)







General technical data	
display version LED	No
<ul style="list-style-type: none"> <li>• protection class IP</li> </ul>	IP20
switching behavior	monostable
design of the switching function	changeover switch
Design of the switching function positively driven	No
reference code acc. to DIN EN 81346-2	U
Design of the relay operating mechanism	poled
Product component Plug-in socket	Yes
Design of the snap-on socket base	Socket with logic isolation
Auxiliary circuit	
<ul style="list-style-type: none"> <li>• number of NC contacts for auxiliary contacts</li> </ul>	0
<ul style="list-style-type: none"> <li>• number of NO contacts for auxiliary contacts</li> </ul>	0
<ul style="list-style-type: none"> <li>• number of CO contacts for auxiliary contacts</li> </ul>	0
Connections/ Terminals	
<ul style="list-style-type: none"> <li>• Product function removable terminal</li> </ul>	No
<ul style="list-style-type: none"> <li>• type of electrical connection</li> </ul>	spring-loaded terminals

<ul style="list-style-type: none"> <li>• type of connectable conductor cross-sections solid</li> </ul>	1x (0,75 ... 1,5), 2x (0,75 ... 1,0), 2x 1,5
<ul style="list-style-type: none"> <li>• Type of connectable conductor cross-sections finely stranded with core end processing</li> </ul>	1x (0,75 ... 1,5), 2x 0,75
<ul style="list-style-type: none"> <li>• Type of connectable conductor cross-sections finely stranded without core end processing</li> </ul>	1x (0,75 ... 1,5), 2x (0,75 ... 1,0), 2x 1,5
<ul style="list-style-type: none"> <li>• Type of connectable conductor cross-sections at AWG conductors solid</li> </ul>	1x (18 ... 16), 2x (18 ... 16)
<ul style="list-style-type: none"> <li>• type of connectable conductor cross-sections at AWG conductors stranded</li> </ul>	1x (18 ... 16), 2x (18 ... 16)
<ul style="list-style-type: none"> <li>• connectable conductor cross-section solid</li> </ul>	0.75 ... 1.5 mm <sup>2</sup>
<ul style="list-style-type: none"> <li>• connectable conductor cross-section finely stranded with core end processing</li> </ul>	0.75 ... 1.5 mm <sup>2</sup>
<ul style="list-style-type: none"> <li>• connectable conductor cross-section finely stranded without core end processing</li> </ul>	0.75 ... 1.5 mm <sup>2</sup>
<b>AWG number as coded connectable conductor cross section</b>	
<ul style="list-style-type: none"> <li>• solid</li> </ul>	18 ... 16
<ul style="list-style-type: none"> <li>• stranded</li> </ul>	18 ... 16

Installation/ mounting/ dimensions	
<ul style="list-style-type: none"> <li>• mounting position</li> </ul>	any
<ul style="list-style-type: none"> <li>• mounting type</li> </ul>	snap-on mounting
height	98 mm
width	28 mm
depth	48.3 mm

Ambient conditions	
<ul style="list-style-type: none"> <li>• ambient temperature during operation</li> </ul>	-40 ... +70 °C
<ul style="list-style-type: none"> <li>• ambient temperature during storage</li> </ul>	-25 ... +70 °C
<ul style="list-style-type: none"> <li>• ambient temperature during transport</li> </ul>	-25 ... +70 °C

### Certificates/ approvals

General Product Approval	Declaration of Conformity	Marine / Ship- ping	other
 UL	 VDE		<a href="#">Miscellaneous</a>  LRS <a href="#">Confirmation</a>

### Further information

**Information- and Downloadcenter (Catalogs, Brochures,...)**  
<https://www.siemens.com/ic10>

**Industry Mall (Online ordering system)**  
<https://mall.industry.siemens.com/mall/en/en/Catalog/product?mlfb=LZS:PT7874P>

**Cax online generator**

<http://support.automation.siemens.com/WW/CAXorder/default.aspx?lang=en&mlfb=LZS:PT7874P>

**Service&Support (Manuals, Certificates, Characteristics, FAQs,...)**

<https://support.industry.siemens.com/cs/ww/en/ps/LZS:PT7874P>

**Image database (product images, 2D dimension drawings, 3D models, device circuit diagrams, EPLAN macros, ...)**

[http://www.automation.siemens.com/bilddb/cax\\_de.aspx?mlfb=LZS:PT7874P&lang=en](http://www.automation.siemens.com/bilddb/cax_de.aspx?mlfb=LZS:PT7874P&lang=en)

**Characteristic: Derating**

<https://support.industry.siemens.com/cs/ww/en/ps/LZS:PT7874P/manual>

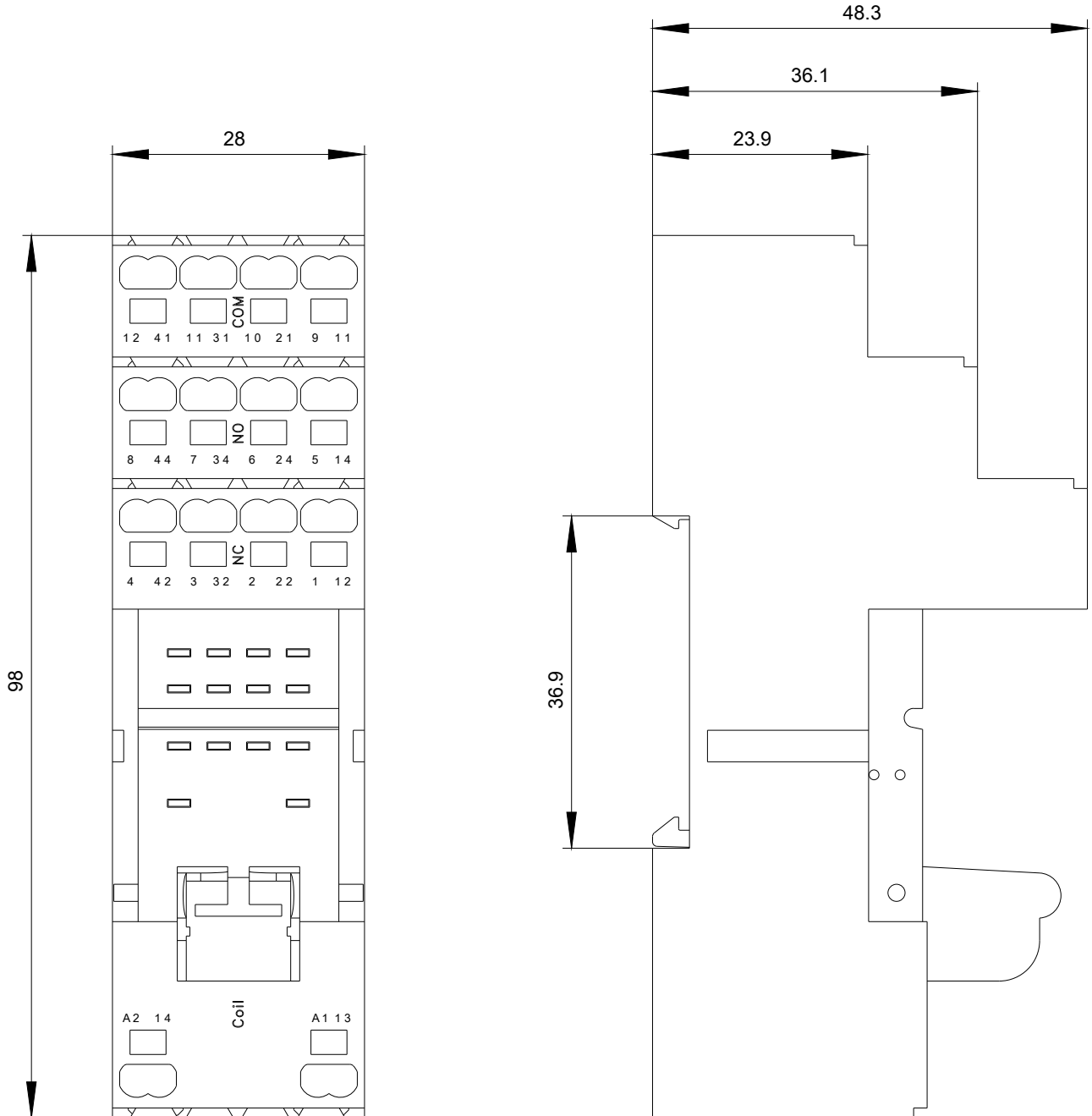

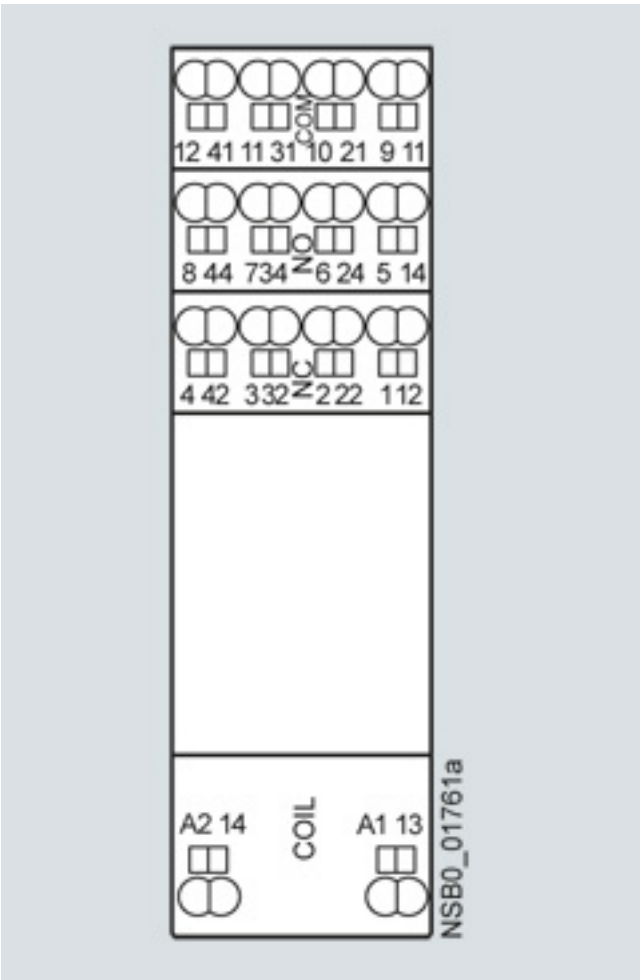

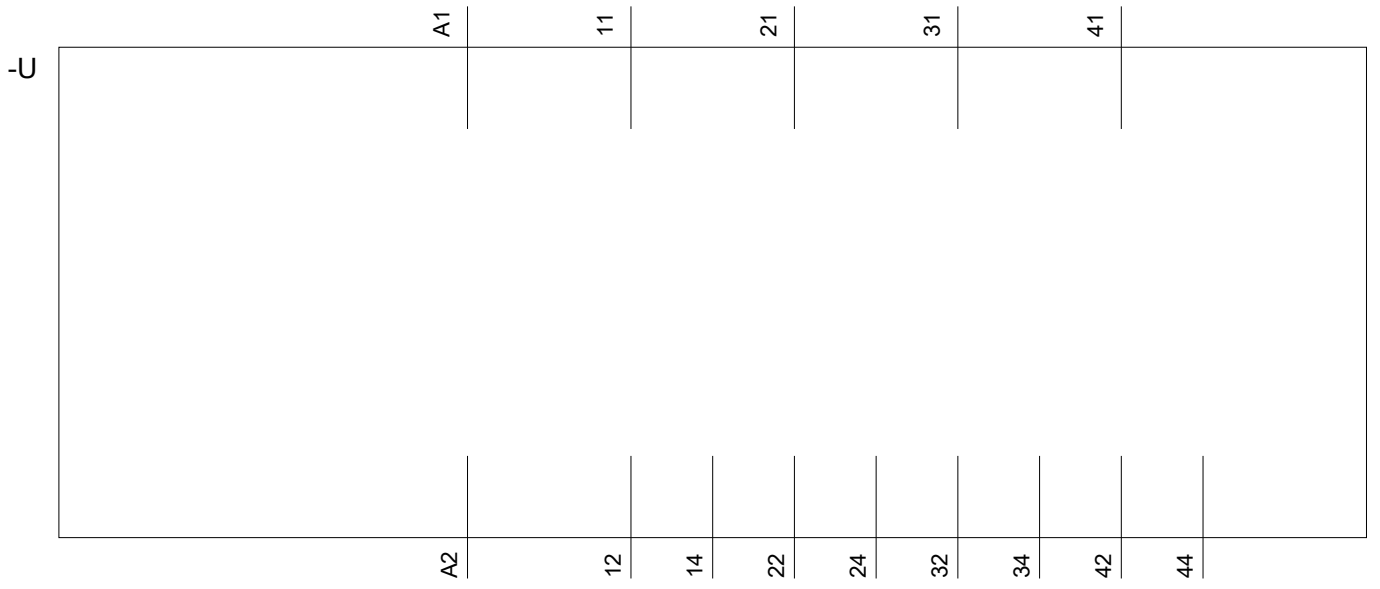

last modified:

08/18/2020