

KEP 9/11

Enlargement adaptor, polyamide, RAL 7035, Pg9 / Pg11

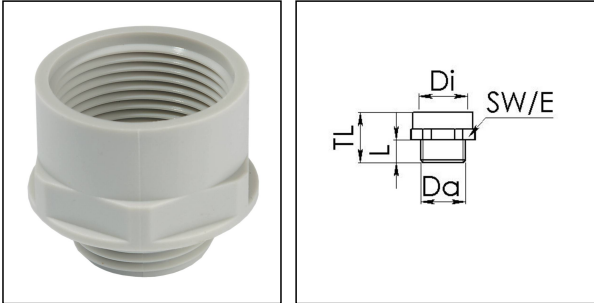

Products may differ in size, colour and appearance to those shown. If you require further information or customisation, please contact us directly.



Material	Polyamide, fibre reinforced
Temp. range min	-40 °C
Temp. range max	100 °C
Glow wire test	650 °C
Thread type outer	PG
Ø outer thread	9
Length screw-in thread L	9 mm
Thread type inner	PG
Ø inner thread	11
Length internal thread	15,5 mm
Total length TL	27 mm
Key width SW	22 mm
Collar diameter (E)	24 mm
Product Color	RAL 7035
Order no. RAL 7035	10063596
Type	KEP 9/11
Packing unit	100
ETIM-Classification	EC000938

Recommended accessories

MUG 9	10060671
ADR 9	10061420

14.01.2021

Your Contact:

WISKA Hoppmann GmbH

Kisdorfer Weg 28 · 24568 Kaltenkirchen · Germany

☎ +49-4191-508-0 · 📠 +49-4191-508-209

contact@wiska.de · www.wiska.com

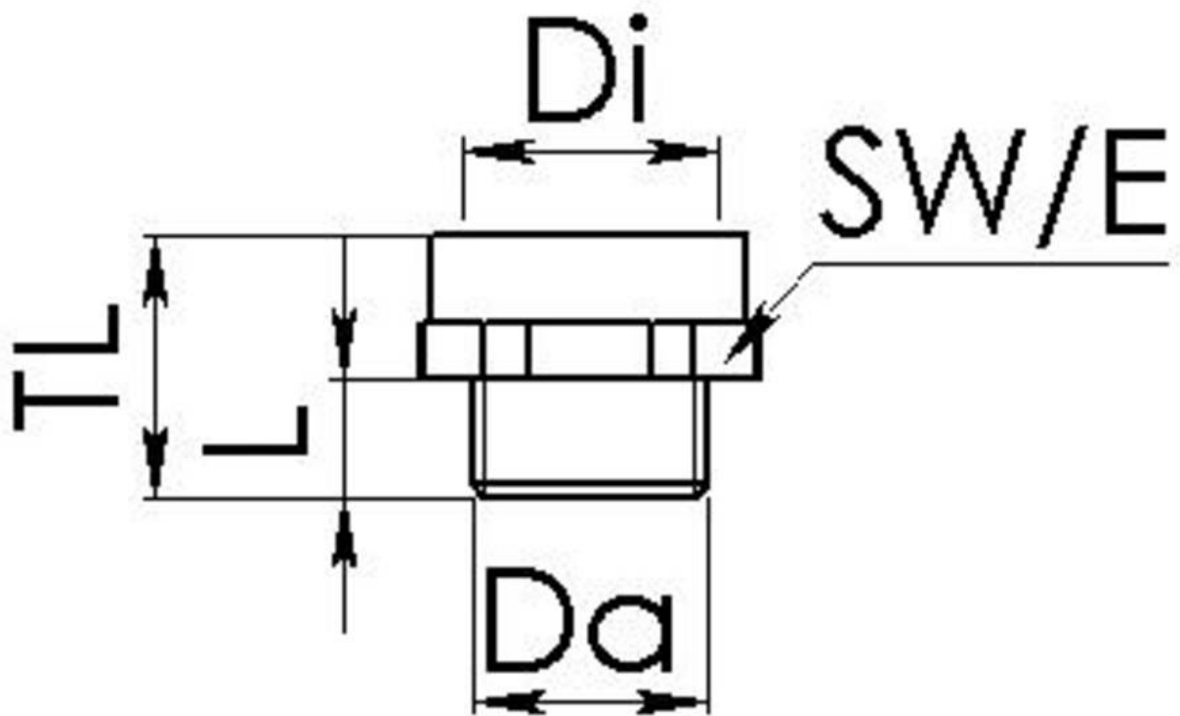

Your Contact:

WISKA Hoppmann GmbH

Kisdorfer Weg 28 · 24568 Kaltenkirchen · Germany

☎ +49-4191-508-0 · 📠 +49-4191-508-209

contact@wiska.de · www.wiska.com