

KEP 13,5/16

Enlargement adaptor, polyamide, RAL 7035, Pg13,5 / Pg16

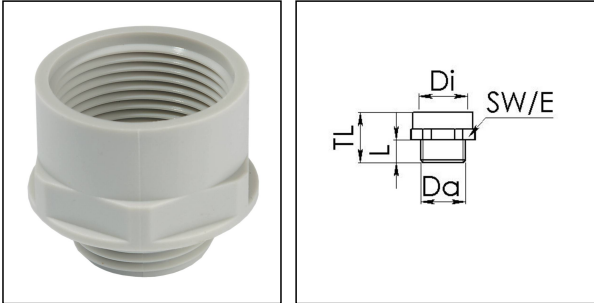

Products may differ in size, colour and appearance to those shown. If you require further information or customisation, please contact us directly.



Material	Polyamide, fibre reinforced
Temp. range min	-40 °C
Temp. range max	100 °C
Glow wire test	650 °C
Thread type outer	PG
Ø outer thread	13,5
Length screw-in thread L	10 mm
Thread type inner	PG
Ø inner thread	16
Length internal thread	15,5 mm
Total length TL	28 mm
Key width SW	27 mm
Collar diameter (E)	30 mm
Product Color	RAL 7035
Order no. RAL 7035	10063598
Type	KEP 13,5/16
Packing unit	100
ETIM-Classification	EC000938

Recommended accessories

MUG 13,5	10060673
ADR 13,5	10061422

14.01.2021

Your Contact:

WISKA Hoppmann GmbH

Kisdorfer Weg 28 · 24568 Kaltenkirchen · Germany

☎ +49-4191-508-0 · 📠 +49-4191-508-209

contact@wiska.de · www.wiska.com

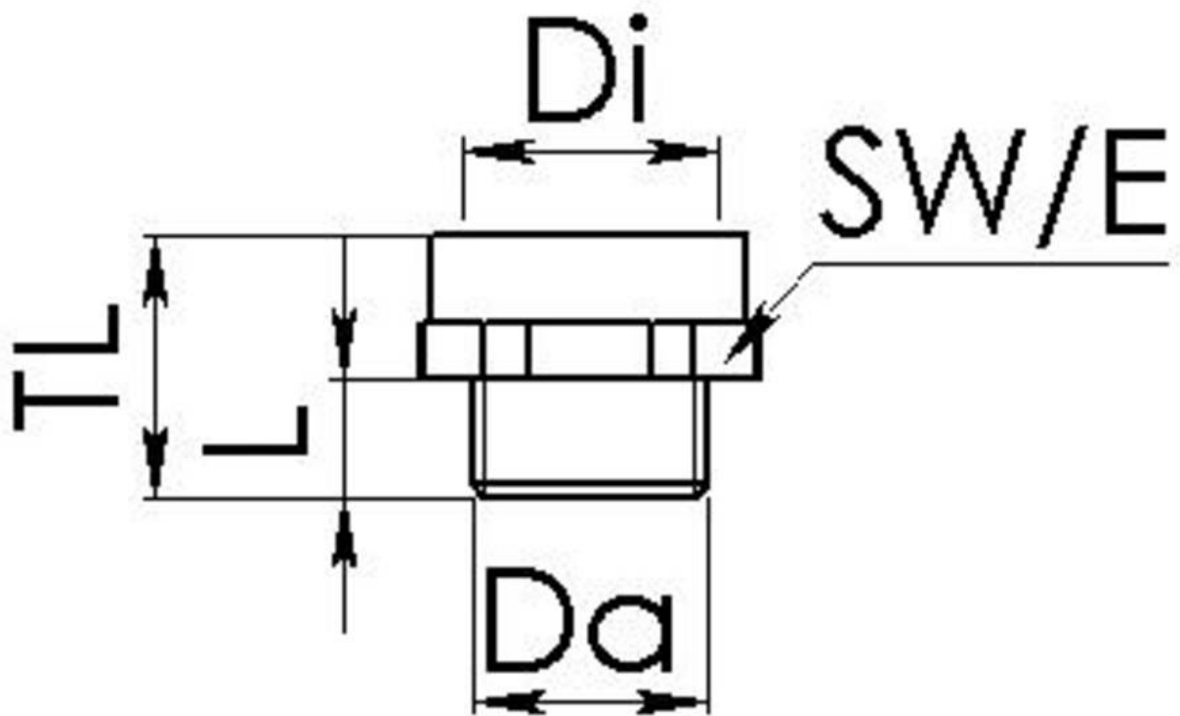

Your Contact:

WISKA Hoppmann GmbH

Kisdorfer Weg 28 · 24568 Kaltenkirchen · Germany

☎ +49-4191-508-0 · 📠 +49-4191-508-209

contact@wiska.de · www.wiska.com